

BAFFLE HEIGHT	
Nominal	Actual
6"	5.5"
8"	7.5"
10"	9.25"
12"	11.25"

BAFFLE WIDTH	
Nominal	Actual
2"	1.5"

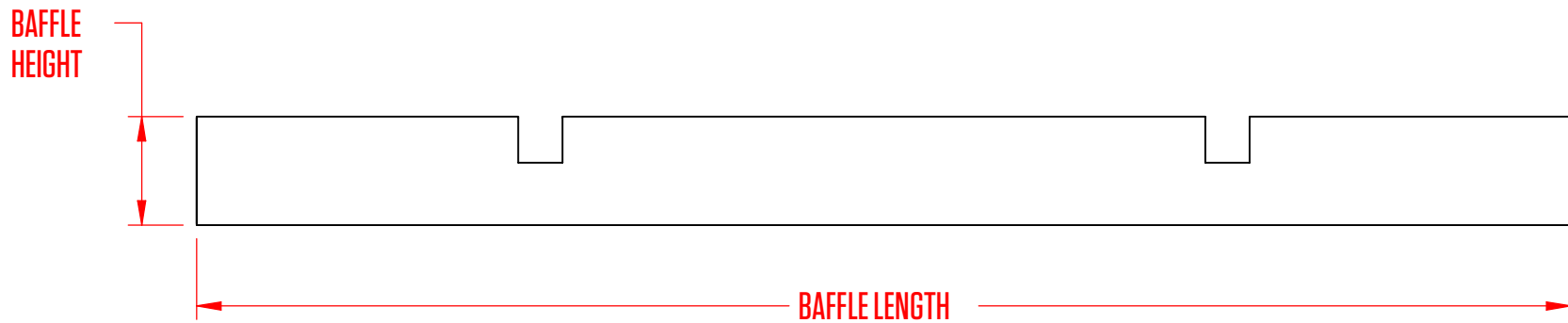

**Note : Actual length will be 1" shorter than the Nominal length,
Unless it is specified. Max length of a single baffle along
the system width will be 95"**

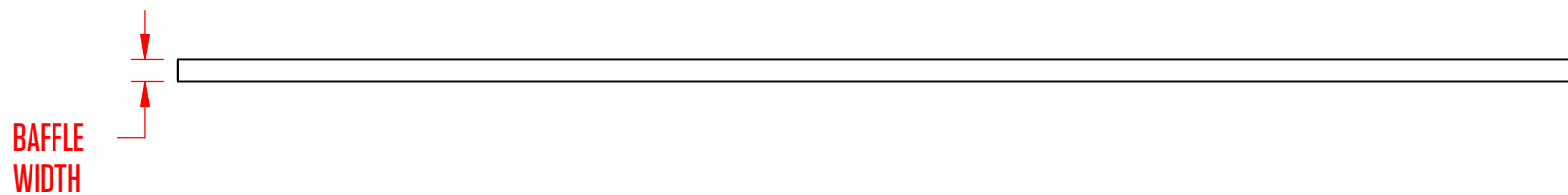

canada: 479 central avenue | fort erie, ontario | L2A 3T9
usa: 266 elmwood avenue, unit 386 | buffalo, new york | 14222
www.barbican.ca | 800 663 5781 | info@barbican.ca

PRODUCT CODE: 25-LUM-01
PRODUCT NAME: FOM Lumber-Lit
CONTACT: sales@barbican.ca

FOM LUMBER LIT - System Width(SW) - 8FT and Under

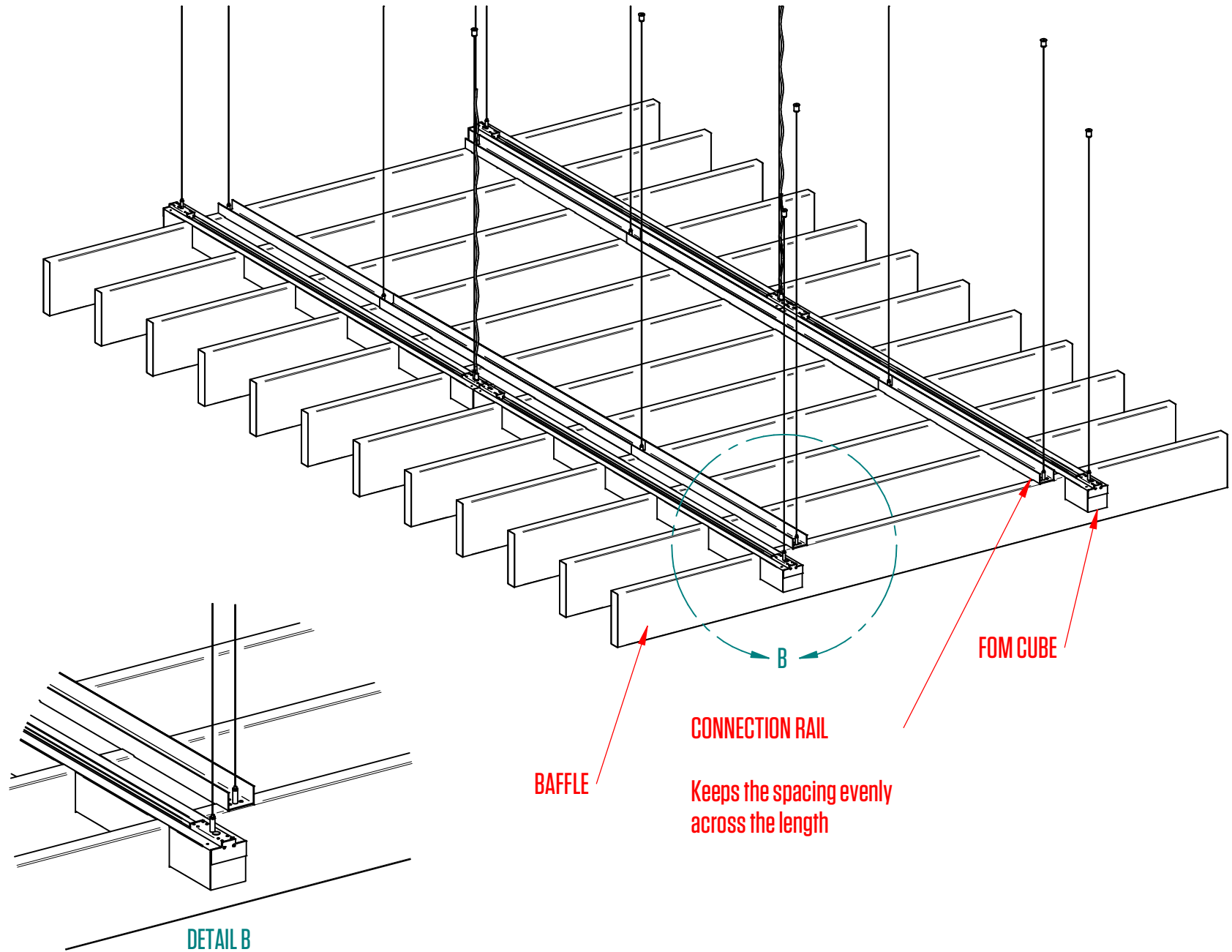

canada: 479 central avenue | fort erie, ontario | L2A 3T9
usa: 266 elmwood avenue, unit 386 | buffalo, new york | 14222
www.barbican.ca | 800 663 5781 | info@barbican.ca

PRODUCT CODE:	25-LUM-01
PRODUCT NAME:	FOM Lumber-Lit
CONTACT:	sales@barbican.ca

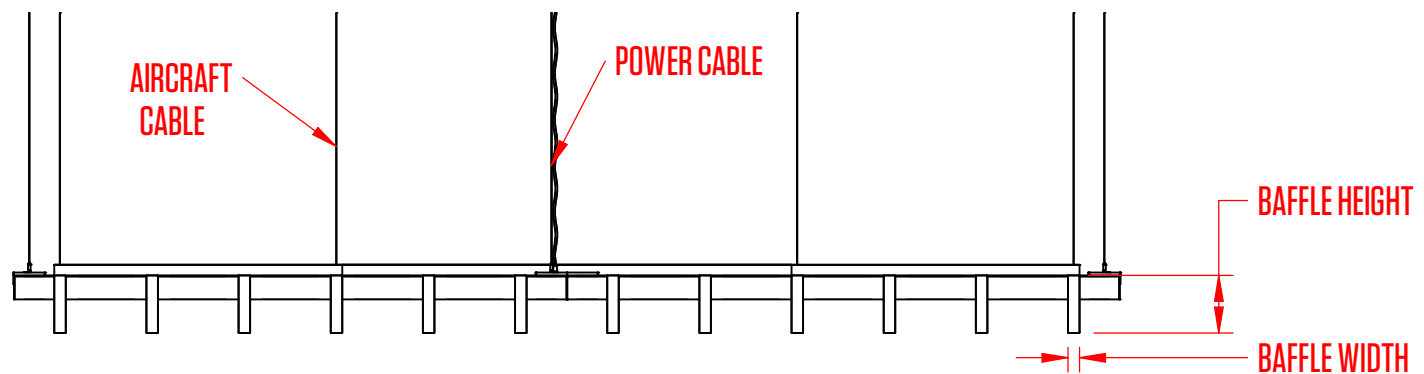
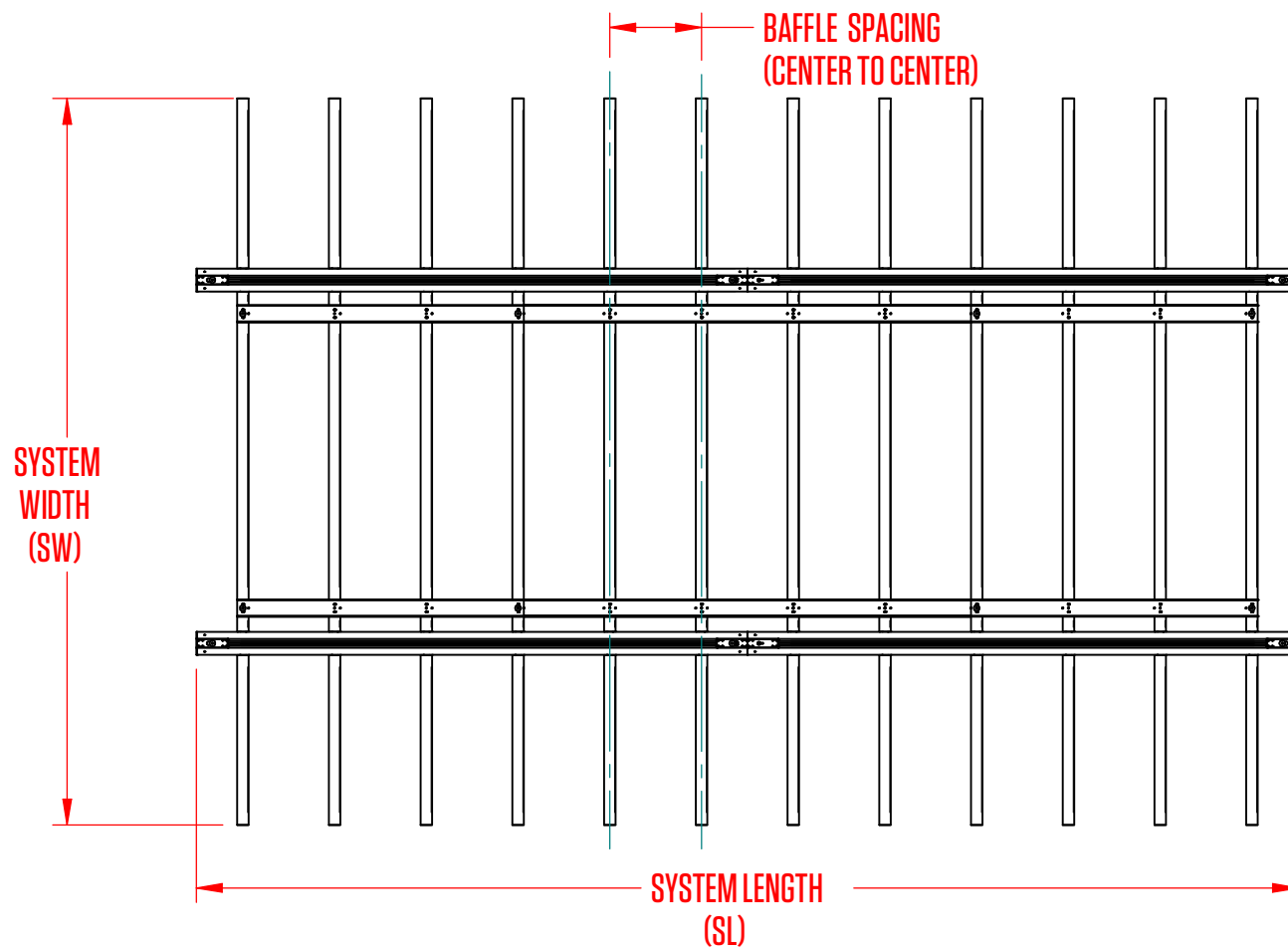

canada: 479 central avenue | fort erie, ontario | L2A 3T9
 usa: 266 elmwood avenue, unit 386 | buffalo, new york | 14222
 www.barbican.ca | 800 663 5781 | info@barbican.ca

PRODUCT CODE:	25-LUM-01
PRODUCT NAME:	FOM Lumber-Lit
CONTACT:	sales@barbican.ca

FOM LUMBER LIT - System Width(SW) - Over 8 FT

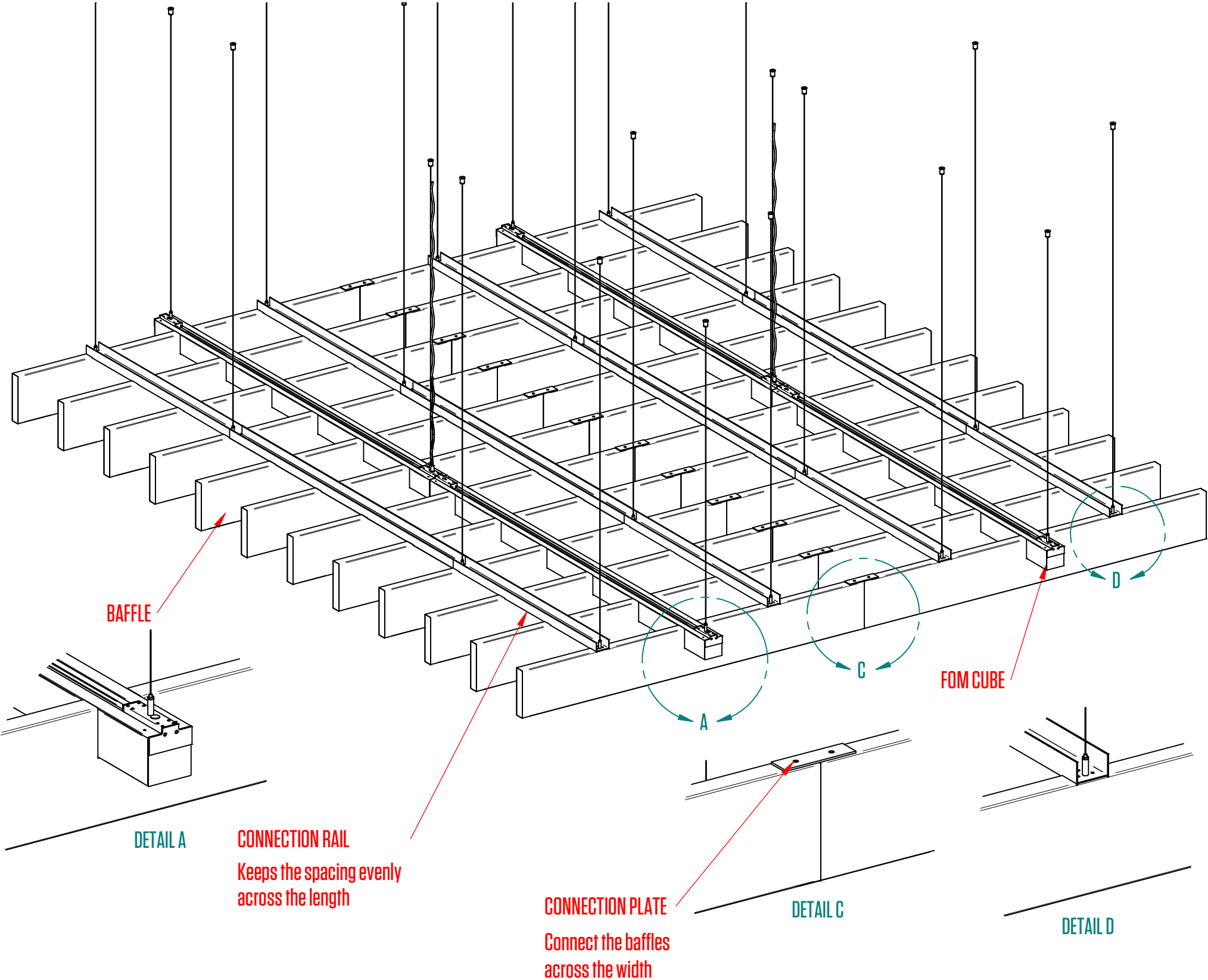

	canada: 479 central avenue fort erie, ontario L2A 3T9 usa: 266 elmwood avenue, unit 386 buffalo, new york 14222 www.barbican.ca 800 663 5781 info@barbican.ca	PRODUCT CODE: 25-LUM-01
		PRODUCT NAME: FOM Lumber-Lit
		CONTACT: sales@barbican.ca